

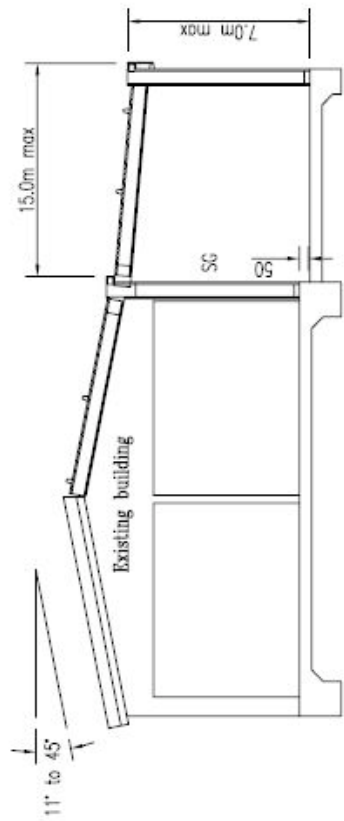

tel: 01463 230666 email: info@rhinosteel.co.uk

Leanto Attachment Details



FRONT ELEVATION

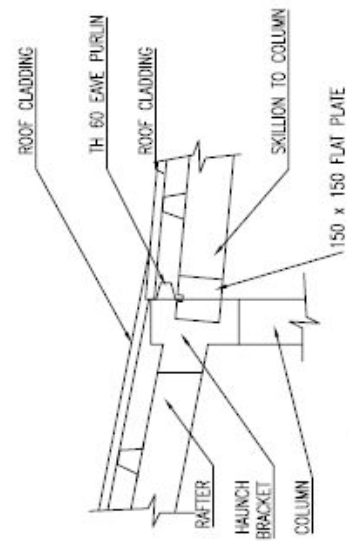

C150 FRAME/TOPSPAN 60 PURLINS & GIRTS.

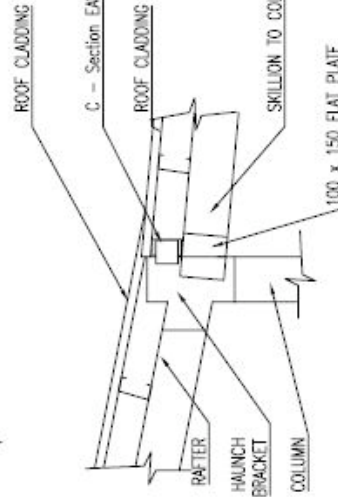

C150 FRAME/Z100 PURLINS & GIRTS, C100 EAVE PURLIN.

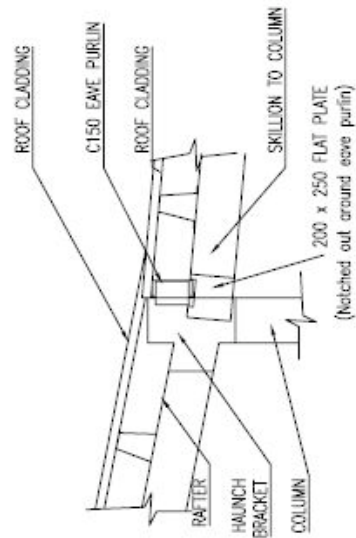

C250 FRAME/TH120 PURLINS & GIRTS, C150 EAVE PURLIN.

NOTE:
WALL CLADDING MUST BE 'SLOTTED' TO ALLOW FLAT PLATE CONNECTION BRACKET TO PASS THROUGH FROM COLUMN TO SKILLION RAFTER.

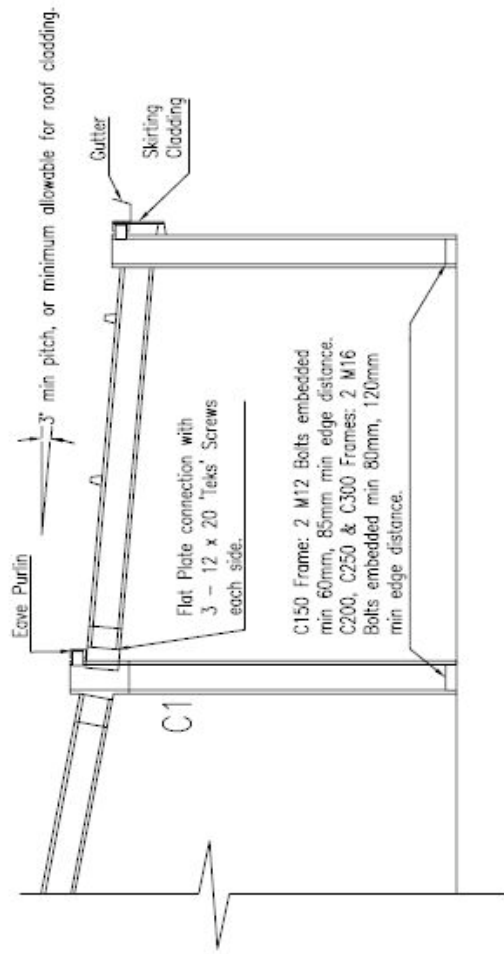

EXPANDED FRONT ELEVATION

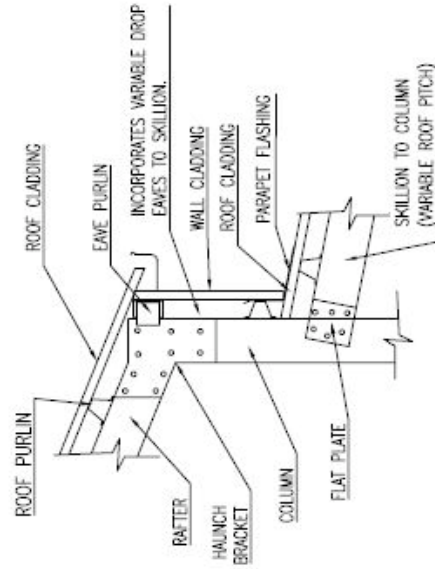

STEP DOWN CONNECTION - OPTION 1 (FLAT PLATE)

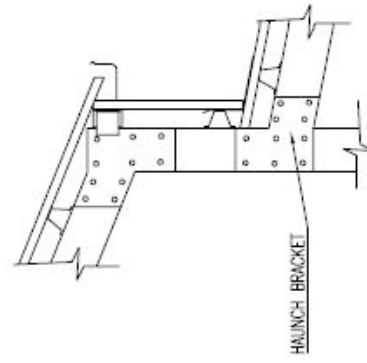

STEP DOWN CONNECTION
OPTION 2 (HAUNCH BRACKET)

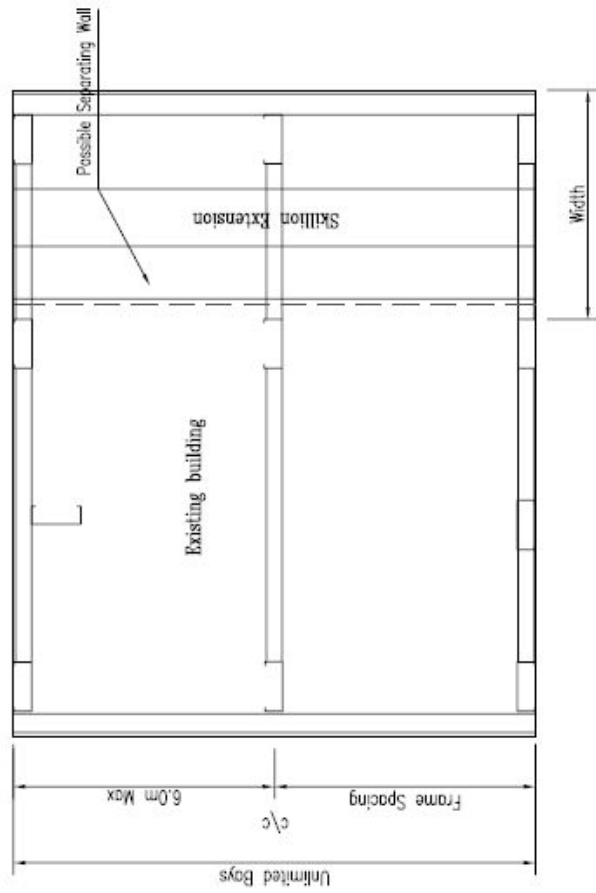

TYPICAL COLUMN LAYOUT.

SKILLIONS > 3.6m Span require End Wall Mullion same dimension as column.
SKILLIONS > 3.6m Span using TH60 must incorporate end wall mullions.
SKILLIONS > 6.0m Span using TH120 must incorporate end wall mullions.

OPTIONS

- Side Wall of Skillions may be: Fully clad, skirting clad or unclad, with gutter attached directly to 'C' section Eaves Purlin.
- End Walls may be fully clad, unclad, or partly clad.
- Doors and Windows may be installed to Side & End Walls.
- Footings or slab Details to be the same as the main building.

NOTE:

This plan must be read in conjunction with sheets 1 through 5.
Sheet 2 of 5 should be used as the Member Schedule, indicating the size of section required and the appropriate connection detail.