

$U = 0.35 \text{ W/m}^2\text{K.}$
 Cavity = 180mm.

PART L FIREWALL - 240 MINS FIREWALL INTEGRITY
 15 MINS INSULATION PERFORMANCE

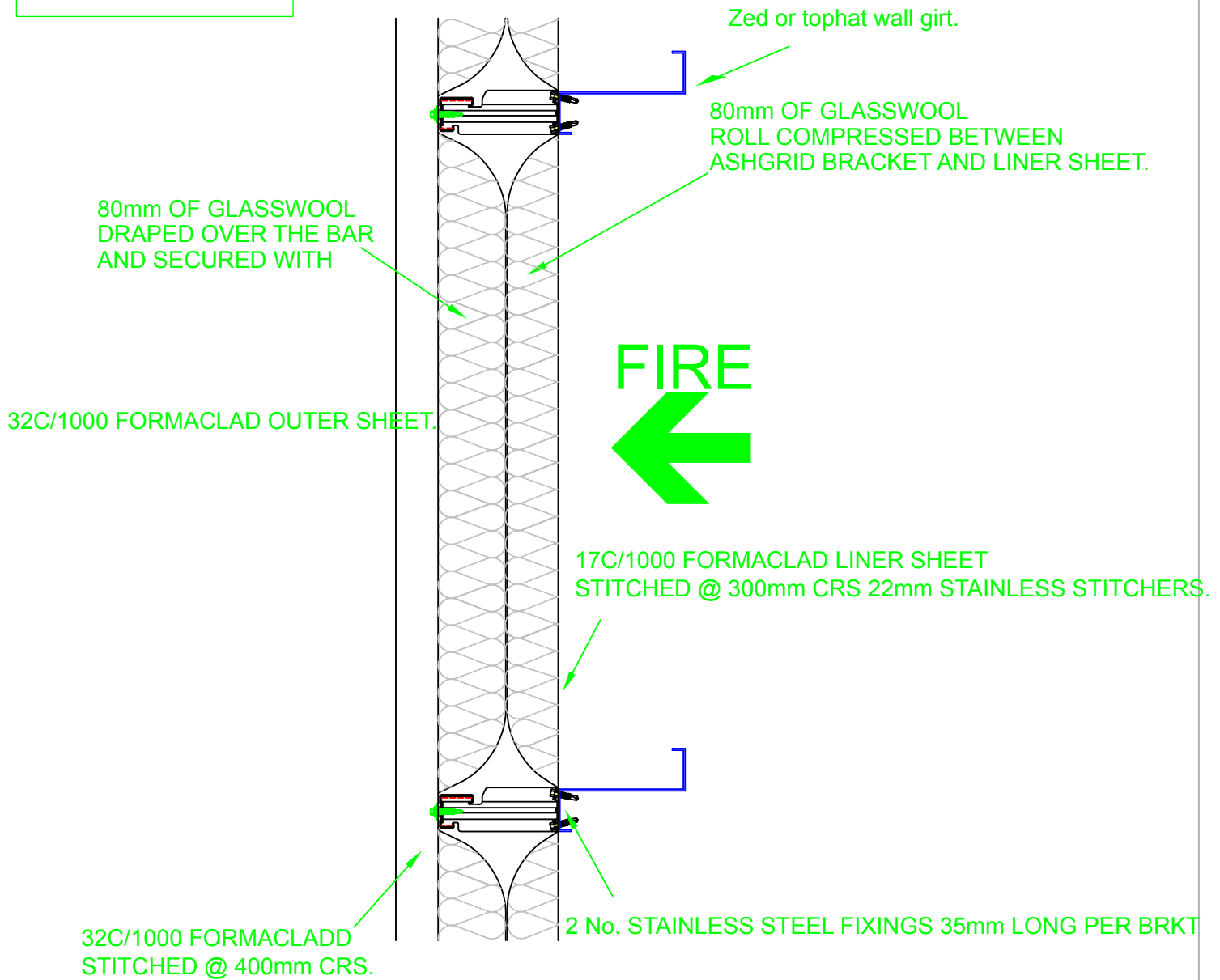

Notes:-

Rails require slots to cater for expansion under fire load. The designer should liase with the structural engineer on this matter.

Bracket centres cannot exceed the width of an insulation strip